



Morris Goding  
Access Consulting

Fitzpatrick + Partners

29-57 Christie Street,  
St Leonards NSW 2065

## **Access Review – DA 2**

18 August 2020





REPORT REVISIONS		
Date	Version	Drawing No / Revision
29/04/2020	1	200428 Christie St WIP Package.
18/08/2020	2	Box download 13/08/20.

This report prepared by:

Lee-May Whong  
Senior Access Consultant  
Morris Goding Access Consulting



## Table of contents

1. Executive Summary	4
2. Introduction	5
2.1 Background	5
2.2 Objectives	6
2.3 Limitations	6
2.4 Statutory Requirements	6
3. General Access Planning Considerations	7
4. Ingress & Egress	8
4.1 External Linkages	8
4.2 Entrances	8
4.3 Emergency Egress	9
5. Paths of Travel	10
5.1 Circulation Areas	10
5.2 Passenger Lifts	10
5.3 Stairs	11
5.4 Ramps	11
6. Amenities and Facilities	12
6.1 Accessible Car Parking Spaces	12
6.2 Sanitary Facilities	12
6.3 Hearing Augmentation	13
6.4 Signage	14
7. Conclusion	15
8. Marked Plans	16



## 1. Executive Summary

The Access Review Report is a key element in the design development of the retail and commercial development located in 29-57 Christie St, St Leonards, and an appropriate response to the AS1428 series, Building Code of Australia (BCA), Premises Standards and ultimately the Commonwealth Disability Discrimination Act (DDA).

Morris Goding Access Consulting has prepared the Access Report to provide advice and strategies to maximise reasonable provisions of access for people with disabilities. The aim of the review is to ensure that the accessibility provisions comply with the relevant statutory requirements, and consideration of a higher degree of accessibility to meet the intent of the DDA of inclusive, dignified and equitable access.



## 2. Introduction

### 2.1 Background

Morris Goding Access Consulting has been engaged to provide an accessibility design review of the proposed development.

The development consists of the retention of the northern commercial building – Building C as a podium, which will accommodate a future tower above. Two new commercial buildings where Building A consists of 8 storeys and Building B of 16 storeys. The extension of the existing basement to provide shared carparking facility over four levels. There is a through-site link between Building A and B, a through-site link between Building B and C.

The development falls under the following BCA classifications and is to be confirmed by the PCA:

- Class 5 – Commercial Offices.
- Class 6 – Retail.
- Class 7a – Carpark.
- Class 9b – Fitness Centre.

The general building access requirements for the above classifications are:

- Class 5 and 6: to and within all areas normally used by the occupants.
- Class 7a: to and within any level containing accessible carparking spaces.
- Class 9b: to and within all areas normally used by the occupants.

The requirements of this review is to:

- Review supplied drawings of the proposed development;
- Provide a report that will analyse the provisions of disability design of the development, and
- Recommend solutions that will ensure the design complies with the Disability Discrimination Act (DDA), Building Code of Australia (BCA), relevant Australian Standards.



## 2.2 Objectives

This report seeks to ensure compliance with statutory requirements, and in addition, considers enhanced benchmark requirements set by the project. It considers the building user groups and attempts to deliver equality, independence and functional access for people with disability; inclusive of:

- People with a mobility impairment (ambulant and wheelchair);
- People with a sensory impairment (hearing and vision); and
- People with a dexterity impairment.

The report seeks to provide compliance with the Disability Discrimination Act. In doing so, it attempts to eliminate, as far as possible, discrimination against persons on the ground of disability.

## 2.3 Limitations

This report is limited to the accessibility provisions of the building in general. It does not provide comment on detailed design issues such as the internals of accessible toilets, ambulant toilets, fit-out, lift specification, slip resistant floor finishes, door schedules, hardware and controls, glazing, luminance contrast, stair nosing, TGSIs, handrail design, signage etc. that will be included in construction documentation.

## 2.4 Statutory Requirements

The relevant statutory and regulatory requirements are:

- Federal Disability Discrimination Act (DDA).
- Disability (Access to Premises – Buildings) Standards 2010.
- Building Code of Australia (BCA) Part D3, E3, F2.
- AS 1428.1:2009 – General Requirement for Access.
- AS 1428.4.1:2009 – Tactile Ground Surface Indicators.
- AS 2890.6:2009 – Parking for People with Disabilities.
- AS 1735.12:1999 – Lift Facilities for Persons with Disabilities.

Additional advisory standards not currently referenced, and other relevant guidelines considered include:

- Universal Design Principles.
- Premises Standard Guideline V2 2013.
- Guide to the BCA 2019.
- AS3745:2010 – Planning for Emergencies in Facilities (to assist with design strategies for provision for escape for people with disability that may require assistance).



### 3. General Access Planning Considerations

The Disability Discrimination Act 1992 (DDA) is a legislative law that protects the rights of all people. The Act makes disability discrimination unlawful and promotes equal rights, equal opportunity and equal access for people with disabilities. The Australian Human Right Commission is the governing body who control and enforce DDA compliance.

Nevertheless, building elements that provide insufficient accessible provisions for people with disabilities remain subject to the DDA. The improvement of non-compliant building elements and areas to meet current access requirements will mitigate the risk of a DDA complaint be made against the building owner.

Since the 1st of May 2011, the Commonwealth's Disability (Access to Premises – Buildings) Standards 2010 (DDA Premises Standards) apply to all new building works and to affected parts of existing buildings.

The requirements of the DDA Premises Standards (DDA Access Code) are mirrored in the access provisions of the BCA. New building work and affected parts must comply with the DDA Premises Standards and AS1428.1:2009 in the same manner as they would comply with the BCA by meeting deemed-to-satisfy provisions or by adopting an alternative solution that achieves the relevant performance requirements.

By utilising AS 1428 suite of Standards, the overall aim is to provide continuous accessible paths of travel to connect the proposed development to and through public domain areas and between associated accessible buildings in accordance with the DDA Access Code.

MGAC supports the use and consideration of universal design (UD) principles into the design to maximise access for all people. We will assist the design team to incorporate UD principles where possible within the project, while still meeting mandatory compliance requirements.

Universal design principles consider the needs of a broad range of people including older people, families with children and pushing prams, people from other cultures and language groups, visitors in transit and people with disability. By considering the diversity of users, the design will embed access into and within it, so that benefits can be maximised, without adding on specialised 'accessible' features that can be costly, visually unappealing and may perpetuate exclusion and potential stigma.

The seven key Universal design principles to consider in the on-going design include:

- Principle 1      Equitable Use
- Principle 2      Flexibility in Use
- Principle 3      Simple and Intuitive Use
- Principle 4      Perceptible Information
- Principle 5      Tolerance for Error
- Principle 6      Low Physical Effort
- Principle 7      Size and Space for Approach and use.



## 4. Ingress & Egress

### 4.1 External Linkages

The BCA and the Premises Standards have requirements for external approaches. The key requirements are:

An accessible path of travel is required to be provided:

- From the main pedestrian entry points at the allotment boundary to all building entrances.
- Between accessible buildings (or parts of buildings).
- From accessible car parking spaces to the building entrance.

#### Assessment:

*Capable of achieving compliance.*

*Accessible path from the allotment boundary to all building entrances and between buildings is provided. Ensure paths are accessible.*

*Paths from the accessible carparking spaces to the entrances via passenger lifts are also provided.*

*Refer marked plans for further comments.*

*Confirm all details at subsequent design stages.*

### 4.2 Entrances

The BCA and the Premises Standards have requirements for building entrances. The key requirements are:

- Access through no less than 50% of all entrances, including the principal pedestrian entrance.
- For buildings greater than 500msq, a non-accessible entrance must be located less than 50m from an accessible entrance.
- Doors to have a minimum 850mm clear opening width and compliant door circulation spaces.

#### Assessment:

*Capable of achieving compliance.*

*Entrances appear appropriate.*

*Confirm all details at subsequent design stages.*

#### Advisory:



*Ramps, walkways and stairs should be provided in reasonably close proximity to any lift access. This provides choice of access and promotes inclusion in line with the DDA and UD principles.*

### **4.3 Emergency Egress**

The BCA and the Premises Standards have requirements for fire isolated stairs. The key requirements are:

- At least one continuous handrail at a consistent height compliant with AS1428.1, Clause 12.

Note that handrails will not comply (without vertical or raked sections) unless treads are offset at intermediate landings; or landing depth is increased. This detail should be considered at early design stages to avoid non-compliance at the construction phase.

- Compliant nosing strip with appropriate luminance contrast.

#### Assessment:

*Capable of achieving compliance.*

*Nosing strips and handrail details have yet to be provided at this early stage.*

*Confirm all details at subsequent design stages.*

#### Advisory:

*Currently there are no mandatory requirements for the provision of fire egress for people with disability and remains an important issue and concern. We recommend consideration for an allocated wheelchair footprint (800 x 1300mm) within the fire isolated stairway, additionally, consideration of an accessible egress strategy with emergency evacuation plan is recommended.*



## 5. Paths of Travel

### 5.1 Circulation Areas

The BCA and the Premises Standards have requirements for accessible paths of travel. The key requirements are:

- A minimum of 1000mm clear path width be provided along an accessible path.
- A 1500 x 1500mm turning space be provided for a wheelchair to make a 90 degree turn.
- A 1540 x 2070mm turning spaces be provided for a wheelchair to make a 180 degree turn within 2m of an end of corridor and at maximum 20m intervals along an access path.
- 1800 x 2000 passing spaces be provided at maximum 20m intervals when a direct line of sight is not available.
- Accessible doors to have a minimum of 850mm clear opening width to the active leaf and appropriate door circulation areas.

#### Assessment:

*The circulation spaces along paths of travel appear appropriate with the exception of:*

- 90 degree turns at front of lift door – from the carparking spaces to the lifts. Refer marked plans.

*Confirm all details at subsequent design stages.*

### 5.2 Passenger Lifts

The BCA and the Premises Standards have requirements for passenger lifts. The key requirements are:

- A minimum of 1100 x 1400mm lift car size for lifts travelling less than 12m.
- A minimum of 1400 x 1600mm lift car size for lifts travelling more than 12m.
- Lift access features be compliant with BCA E3.6 and AS 1735.12.

#### Assessment:

*Capable of achieving compliance.*

*All lifts appear appropriate.*

*Confirm all details at subsequent design stages.*

#### Advisory:

*It is advised that a minimum of 1800mm clear landing depth be provided in front of lift doors at any lift foyer or lobbies to allow for ease of movement.*



### 5.3 Stairs

The BCA and the Premises Standards have requirements for communication stairs. The key requirements are:

- Handrail and handrail extensions be provided on both sides of the stairway.
- Contrasting nosing strip at the edge of the stair riser.
- Tactile indicators with appropriate contrast be provided at the top and bottom of stairway.
- Stairs to set back 900mm from the allotment boundary to ensure handrail extensions and tactile indicators does not encroach into the transverse path of travel.

#### Assessment:

*Capable of achieving compliance.*

*Tactile, nosing strips and handrail details have yet to be provided at this early stage. Refer marked plans for further comments.*

*Confirm all details at subsequent design stages.*

### 5.4 Ramps

The BCA and the Premises Standards have requirements for ramp access. The key requirements are:

- A maximum grade of 1:14 and landings at maximum 9m intervals
- Handrails, handrail extensions and kerb rails on both sides.
- Landing lengths of 1200mm or 1500mm.
- Tactile indicators at the top and bottom of ramp.
- Ramps are required to set back 900mm from the allotment boundary to ensure handrail extensions and tactile indicators do not encroach into the transverse path of travel.

#### Assessment:

*If provided, ensure ramps comply to AS 1428.1 requirements.*

*Confirm all details at subsequent design stages.*



## 6. Amenities and Facilities

### 6.1 Accessible Car Parking Spaces

The BCA and the Premises Standards have requirements for the provision of accessible car parking spaces. The key requirements are:

- Class 5: 1:100 or part thereof.
- Class 6 retail: 1:50 or part thereof.
- Class 9b fitness centre: 1:100 part thereof.
- A standard accessible car parking spaces requires a 2400 x 5400mm parking space and shared area.
- A minimum of 2500mm height clearance is required for the accessible parking spaces.
- A minimum of 2200mm vertical clearance is required from the entry and exits to the accessible car parking spaces (Note: consideration for minimum 2300 – 2400mm head clearance height is preferred and recommended).

#### Assessment:

*Accessible parking for the different BCA classification and use have yet to be provided.*

*Refer marked plans for further comments.*

*The size and layout of the accessible carparking spaces provided appear appropriate.*

*Confirm all details at subsequent design stages.*

#### Advisory:

*All accessible car parking spaces should be located near entrances and lifts to the spaces that it serves and to minimise travel distances and fatigue.*

### 6.2 Sanitary Facilities

The BCA and the Premises Standards have requirements for sanitary facilities. The key requirements are:

- Unisex accessible toilets:
  - 1 unisex accessible toilet be provided on each storey where toilets are provided.
  - Appropriate 1900 x 2300mm clear circulation spaces.
  - If more than 1 bank of toilets are provided on each level, accessible toilet is required at minimum 50% of those banks of toilets.
  - An even number of left hand (LH) and right hand (RH) toilet pan transfers is required throughout the building.
- Accessible showers:



- Where showers are provided, 1 in 10 showers are required to be accessible.
- Appropriate clear circulation spaces.
- Ambulant toilets:
  - A male and female ambulant toilet are required where a bank of toilet are provided in addition to the accessible toilet.
  - Appropriate 900 x 900mm clear circulation spaces in front of toilet pans and at doorways.

**Assessment:**

*Unisex accessible toilets:*

*Capable of achieving compliance.*

*Ensure an even number of LH and RH toilet pan transfers are provided throughout the building.*

*Accessible showers:*

*Where provided, ensure accessible showers meet requirements.*

*Ambulant toilets:*

*Ensure separate male and female ambulant toilets are provided.*

*Confirm all details at subsequent design stages.*

### **6.3 Hearing Augmentation**

The BCA and the Premises Standards have access requirements for the provision of Hearing Augmentation Systems. The key requirements of this provision are:

- A hearing augmentation system must be provided where an inbuilt amplification system is provided (other than the emergency warning).
- In a room in a Class 9b building; or
- In an auditorium, conference room, meeting room or room for judicatory proposes; or
- At ticket office, teller's booth, reception area where the public is screened form the service provider.
- An induction loop to cover minimum 80% of the floor area.
- Receiver systems to cover minimum 95% of the floor area.

**Assessment:**

*Hearing augmentation details have not been provided at this early stage of the design process. Where required by the BCA, ensure details to BCA and AS 1428.1 requirements.*

*Confirm all details at subsequent design stages.*



## 6.4 Signage

The BCA and the Premises Standards have signage requirements. The key requirements are:

- Signage be provided to all male, female, accessible and ambulant toilets. It is to include:
  - Braille and tactile.
  - International symbol of access.
  - 'LH' or 'RH' to indicate a left-hand or right-hand transfer onto toilet pan.
  - Appropriate font size.
- At required fire exits.
- Where hearing augmentation systems are provided.
- Ensure all signage is detectable with raised symbols and 30% luminance contrast to its background, and in turn, contrasts with the background wall surface.
- Directional signage is required at:
  - Banks of toilets without an accessible toilet, to direct person to the nearest accessible toilet.
  - Non-accessible entrances to direct persons to an accessible entrance.
- Signage to be located on the wall, adjacent to latch side of the door, between 1200 - 1600mm AFFL (or for single line of tactile text: located between 1250 - 1350mm AFFL).

### Assessment:

*Signage details is not provided at this early stage. Ensure directional signage is provided at the stair between Building C and B. Refer marked plans.*

*Confirm all details at subsequent design stages.*



## 7. Conclusion

MGAC has reviewed the proposed development. The drawings indicate that access requirements can readily be achieved subject to the recommendations noted in the marked plans and within this report being addressed during further design stages.

It is advised that MGAC will work with the project team as the scheme progresses to ensure appropriate outcomes are achieved through the developmental design stages and during the construction phase.



## 8. Marked Plans



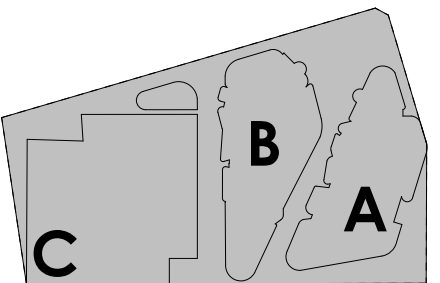
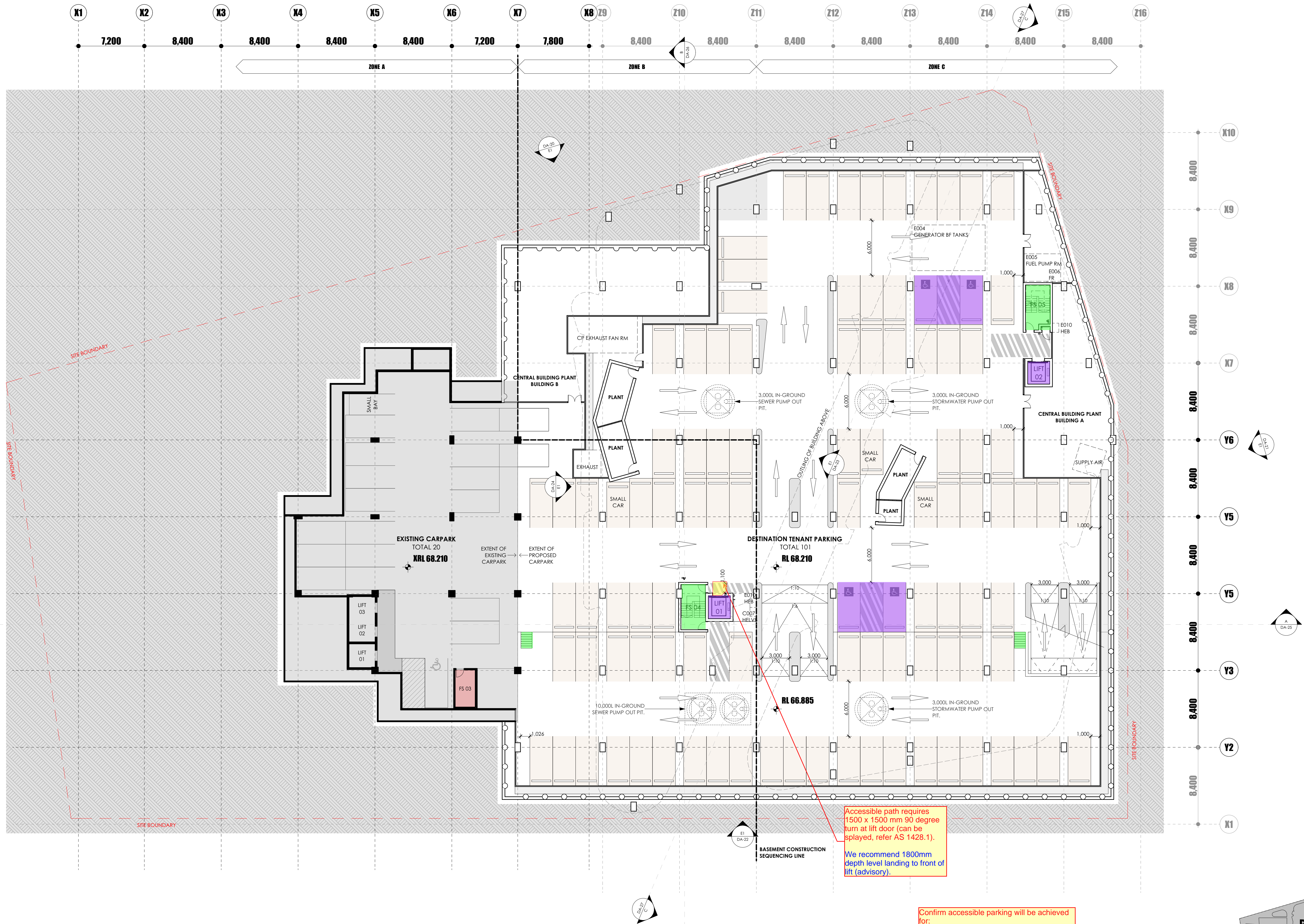







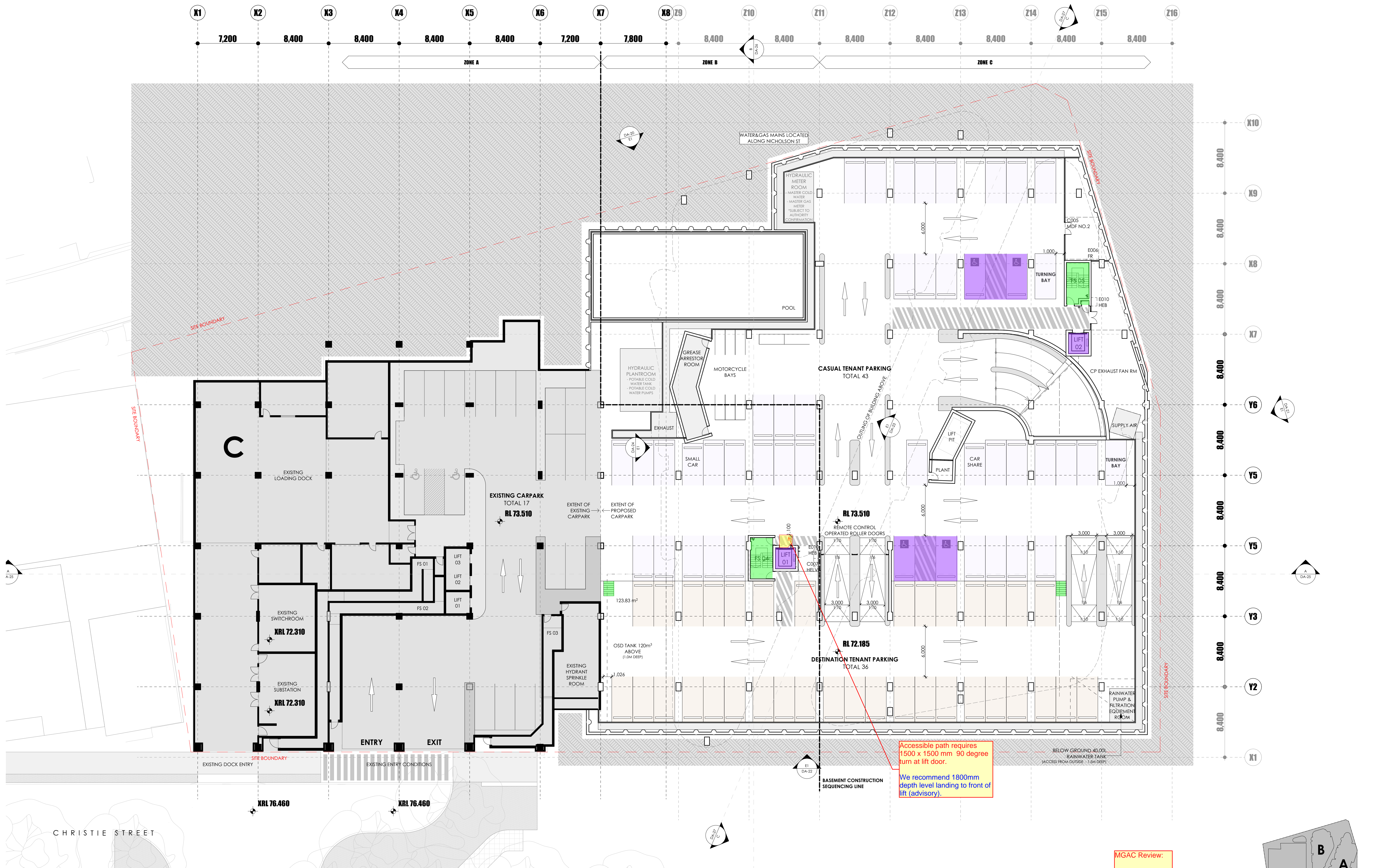

fitzpatrick+partners

© Copyright 2019  
p. +61 (0)2 8274 8200 w. www.fitzpatrickpartners.com  
a. LEVEL 0, 156 CLARENCE STREET, SYDNEY 2000, AUSTRALIA

This drawing is based upon the condition it is not correct, reproduced, retained or disclosed to any unauthorised person without written or in part without prior consent in writing of fitzpatrick+partners.  
Do not scale drawings. Check dimensions before commencing work.  
Drawings show design intent only. Shop drawings are to be provided for approval prior to construction or manufacture.  
Inconsistencies are to be reported to fitzpatrick + partners.

AMENDMENTS  
REV. DATE DESCRIPTION  
A 09.05.2020 PRE DA ISSUE  
B 31.07.2020 DRAFT DA ISSUE

CHK  
JF  
JF

FOR

Arrow  
CAPITAL PARTNERS

STARWOOD  
CAPITAL GROUP

PROJECT  
29-57 CHRISTIE STREET  
COMMERCIAL DEVELOPMENT  
29-57 CHRISTIE STREET, ST LEONARDS NSW 2065  
PROJECT NORTH

MGAC Review:  
15/08/2020

DRAWN APPROVED  
JF JF  
PRINT DATE  
12/08/2020

SCALE @ A1  
1:200

DRAWING  
DEVELOPMENT APPLICATION  
BASEMENT 01  
**DRAFT**  
STATUS  
DA  
PROJECT NO.  
21811  
DRAWING NO.  
DA-08  
ISSUE  
A











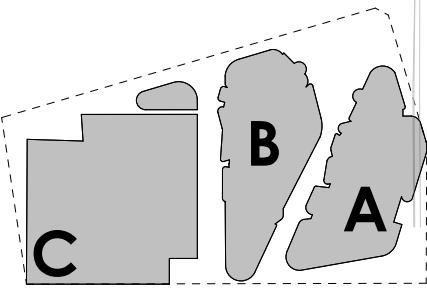



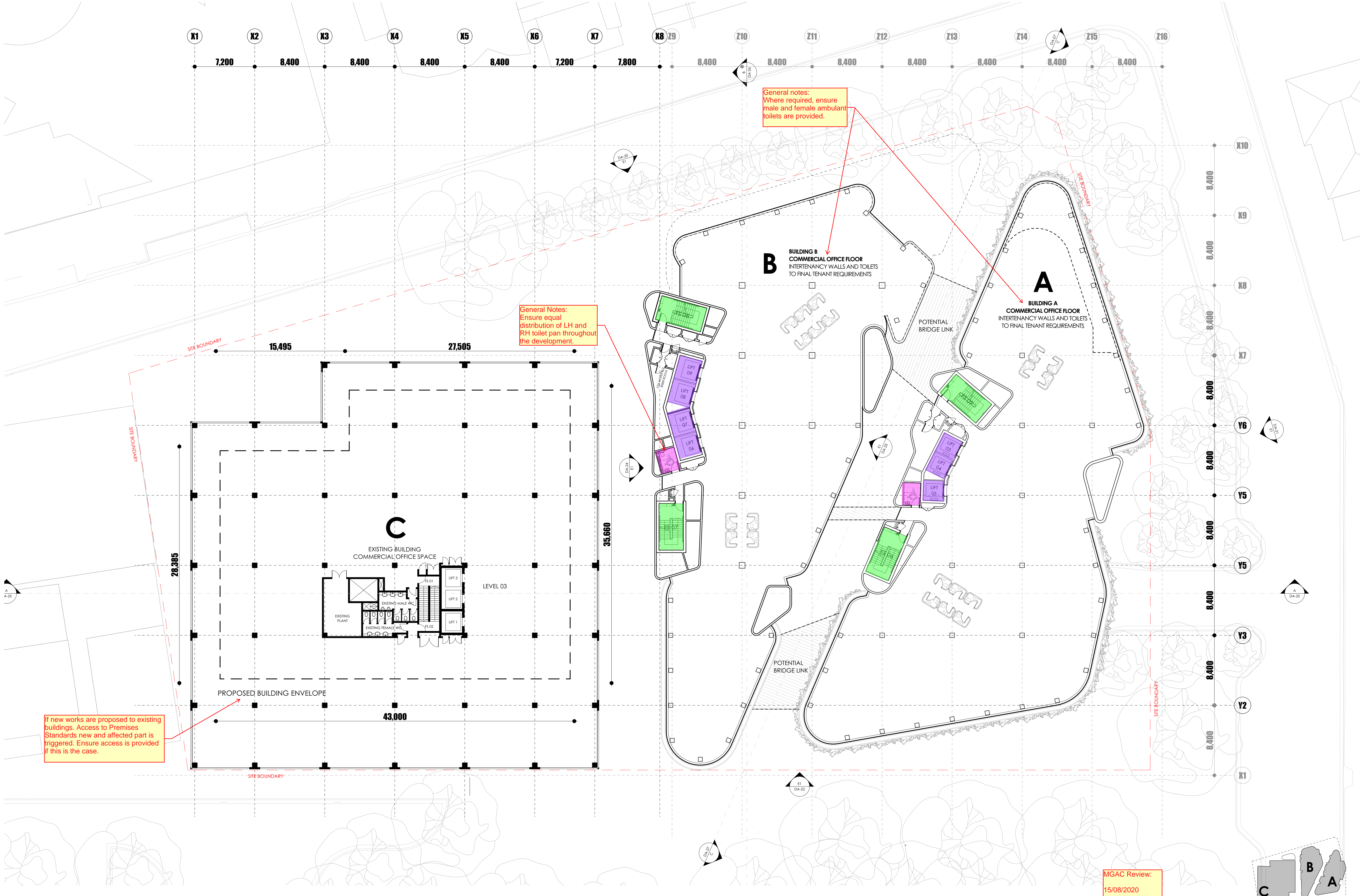



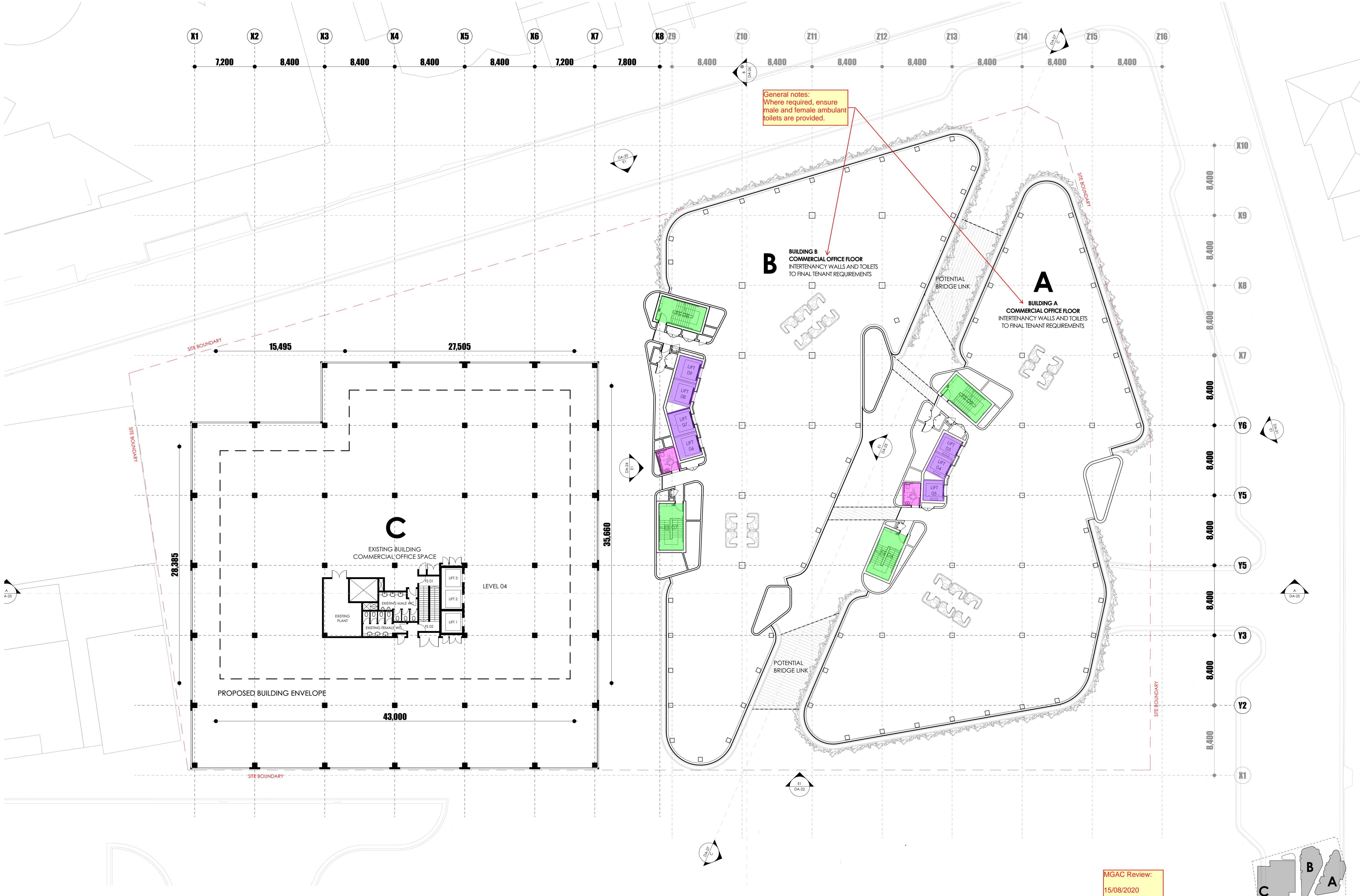

fitzpatrick+partners

© Copyright 2019  
p. +61 (0)2 8274 8200 w. www.fitzpatrickpartners.com  
a. LEVEL 0, 156 CLARENCE STREET, SYDNEY 2000, AUSTRALIA

This drawing is based upon the condition it is not copied, reproduced, retained or disclosed to any unauthorised person without written or in part without prior consent in writing of fitzpatrick+partners.  
Do not scale drawings. Check dimensions before commencing work.  
Drawings show design intent only. Shop drawings are to be provided for approval prior to construction or manufacture.  
Inconsistencies are to be reported to fitzpatrick + partners.

REV.	DATE	DESCRIPTION
A	09.05.2020	PRE DA ISSUE
B	31.07.2020	DRAFT DA ISSUE

CHK  
JF  
JF

FOR



PROJECT  
29-57 CHRISTIE STREET  
COMMERCIAL DEVELOPMENT  
29-57 CHRISTIE STREET, ST LEONARDS NSW 2065  
PROJECT NORTH

SCALE @ A1  
1:200  
50mm ON ORIGINAL

MGAC Review:  
15/08/2020

DRAWN	APPROVED	PRINT DATE	DRAWING
JF	JF	12/08/2020	DEVELOPMENT APPLICATION LEVELS 02 to 03 PLAN <b>DRAFT</b>
STATUS	PROJECT NO.	DRAWING NO.	ISSUE
DA	21811	DA-13	A

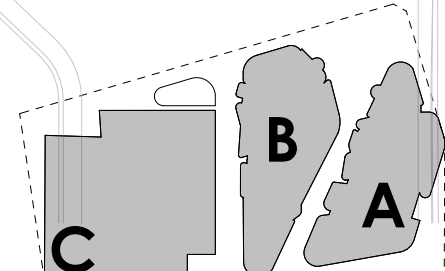



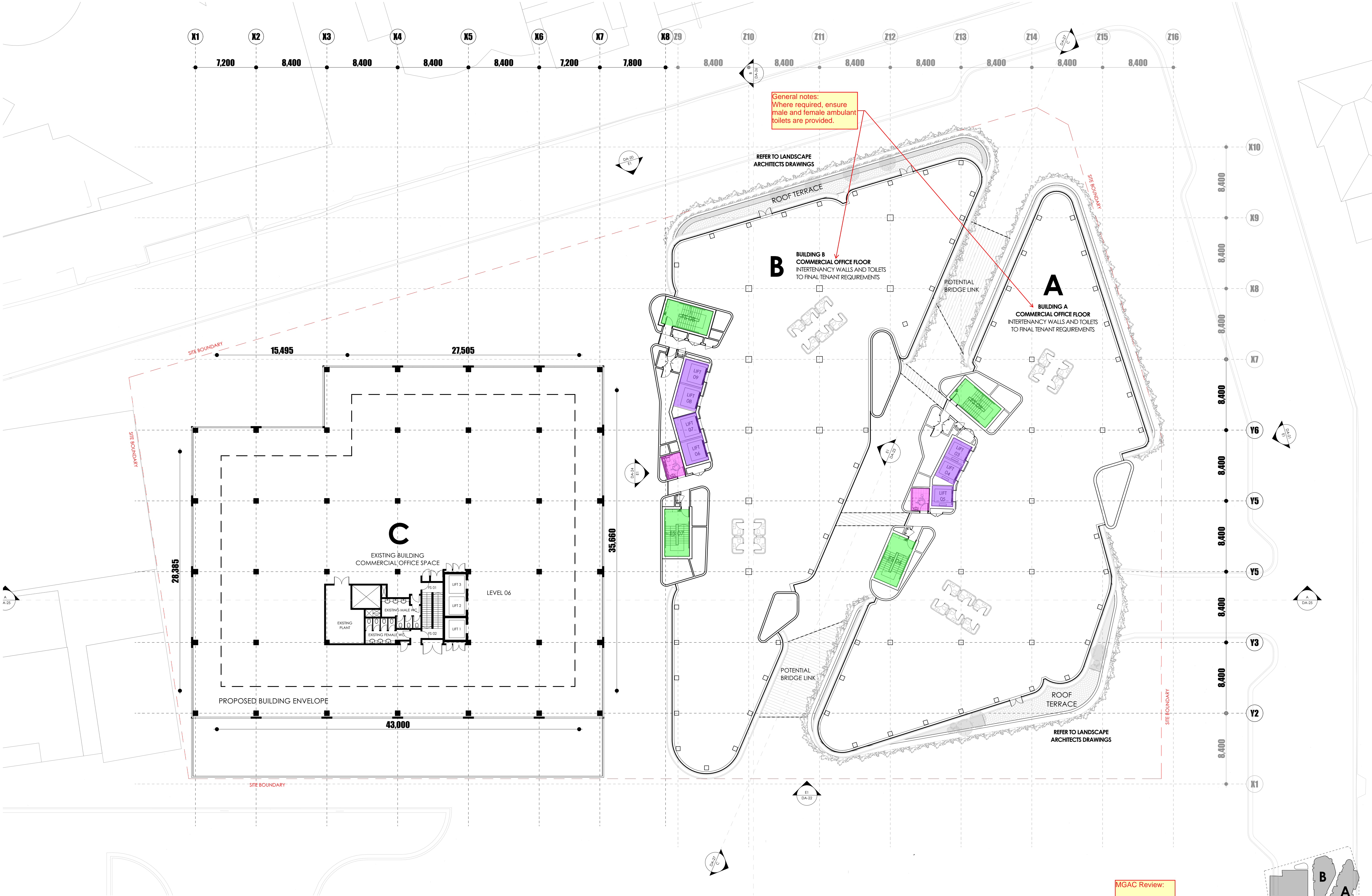



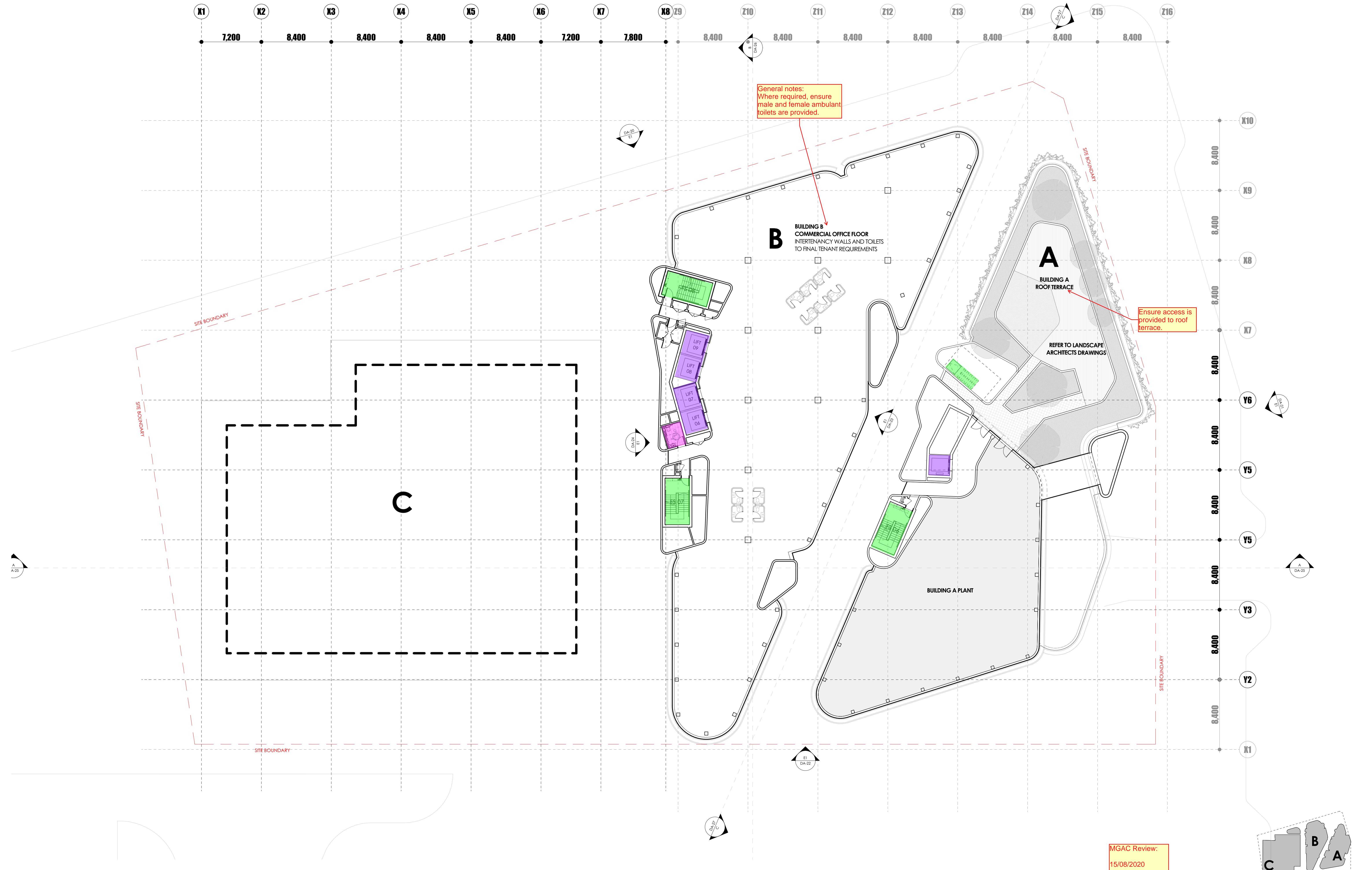

This drawing is based upon the condition it is not copied, reproduced, retained or disclosed to any unauthorised person without written or in part without prior consent in writing of fitzpatrick+partners.  
Do not scale drawings. Check dimensions before commencing work.  
Drawings show design intent only. Shop drawings are to be provided for approval prior to construction or manufacture.  
Inconsistencies are to be reported to fitzpatrick + partners.

REV.	DATE	DESCRIPTION
A	09.05.2020	PRE DA ISSUE
B	31.07.2020	DRAFT DA ISSUE

CHK  
JF  
JF

FOR



PROJECT  
29-57 CHRISTIE STREET  
COMMERCIAL DEVELOPMENT  
29-57 CHRISTIE STREET, ST LEONARDS NSW 2065  
PROJECT NORTH

MGAC Review:  
15/08/2020

DRAWN	APPROVED	PRINT DATE	DRAWING
JF	JF	12/08/2020	DEVELOPMENT APPLICATION LEVEL 07 PLAN <b>DRAFT</b>
SCALE @ A1 1:200	STATUS DA	PROJECT NO. 21811	DRAWING NO. DA-15 ISSUE A

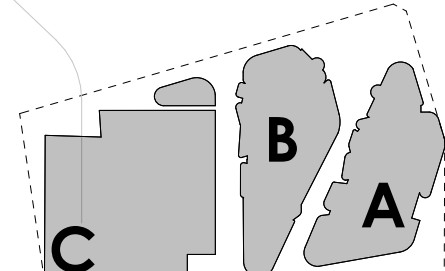



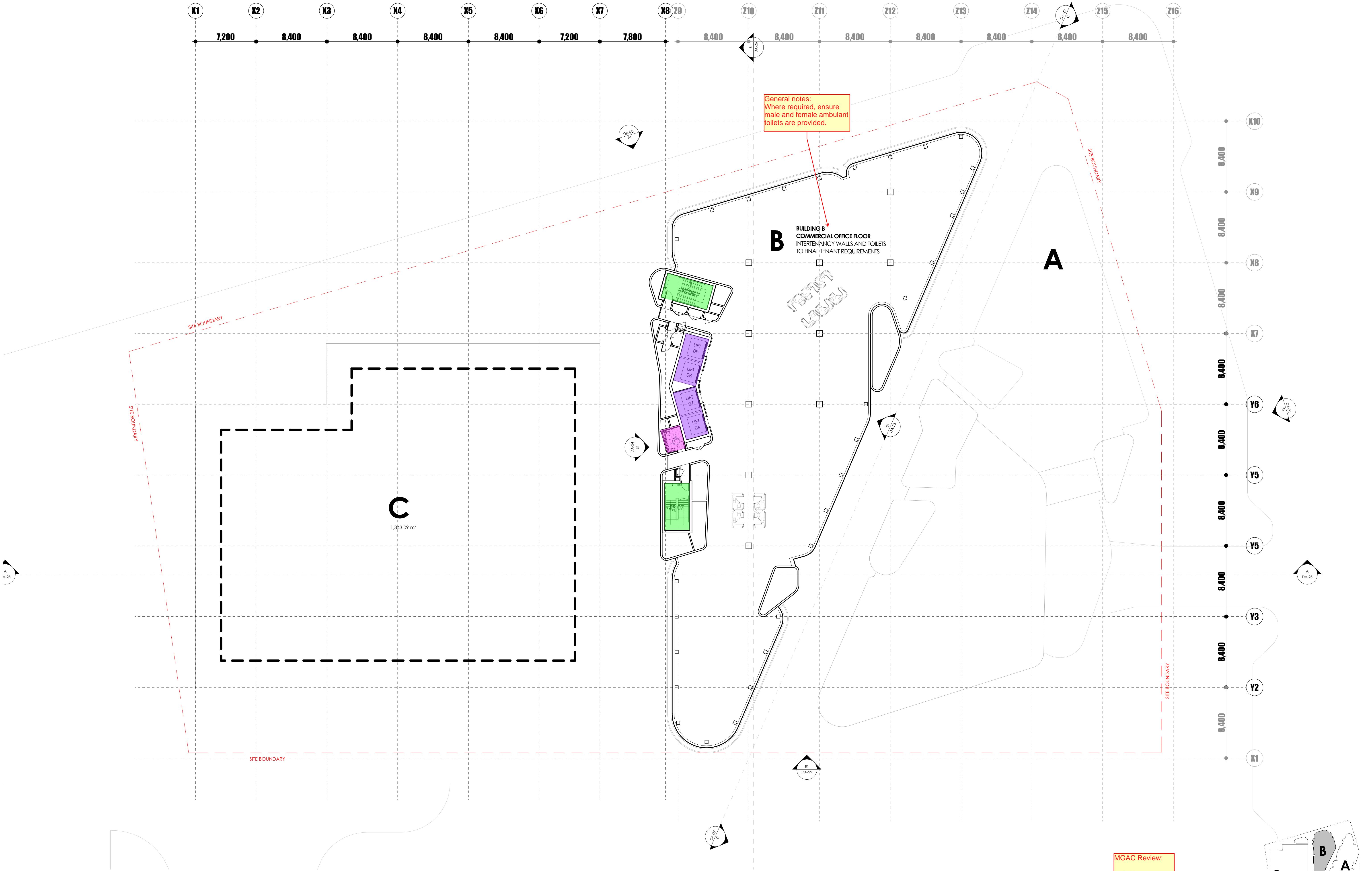

fitzpatrick+partners

© Copyright 2019  
p. +61 (0)2 8274 8200 w. www.fitzpatrickpartners.com  
a. LEVEL 2, 156 CLARENCE STREET, SYDNEY 2000, AUSTRALIA

This drawing is based upon the condition it is not copied, reproduced, retained or disclosed to any unauthorised person without written or in part without prior consent in writing of fitzpatrick+partners.  
Do not scale drawings. Check dimensions before commencing work.  
Drawings show design intent only. Shop drawings are to be provided for approval prior to construction or manufacture.  
Inconsistencies are to be reported to fitzpatrick + partners.

REV.	DATE	DESCRIPTION
A	09.05.2020	PRE DA ISSUE
B	31.07.2020	DRAFT DA ISSUE

CHK  
JF  
JF

FOR

**Arrow**  
CAPITAL PARTNERS

**STARWOOD**  
CAPITAL GROUP

PROJECT  
29-57 CHRISTIE STREET  
COMMERCIAL DEVELOPMENT  
29-57 CHRISTIE STREET, ST LEONARDS NSW 2065  
PROJECT NORTH

50mm ON ORIGINAL

MGAC Review:  
15/08/2020

DRAWN	APPROVED	PRINT DATE	DRAWING
JF	JF	12/08/2020	DEVELOPMENT APPLICATION LEVELS 08 to 09 PLAN <b>DRAFT</b>
STATUS	PROJECT NO.	DRAWING NO.	ISSUE
DA	21811	DA-16	A



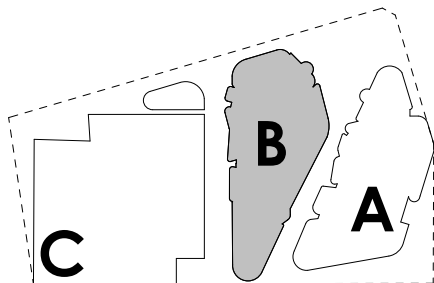
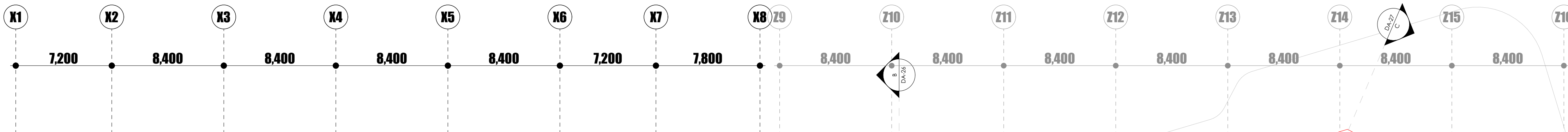

This drawing is issued upon the condition it is not copied, reproduced, retained or disclosed to any unauthorised person either wholly or in part without prior consent in writing of fitzpatrick+partners.  
Do not scale drawings. Check dimensions before commencing work.  
Drawings show design intent only. Shop drawings are to be provided for approval prior to construction or manufacture.  
Inconsistencies are to be reported to fitzpatrick + partners.

AMENDMENTS		
REV.	DATE	DESCRIPTION
A	09.05.2020	PRE DA ISSUE
B	31.07.2020	DRAFT DA ISSUE

CHK:  
JF  
JF

FOR



PROJECT  
29-57 CHRISTIE STREET  
COMMERCIAL DEVELOPMENT  
29-57 CHRISTIE STREET, ST LEONARDS NSW 2065  
PROJECT NORTH



50mm ON ORIGINAL

DRAWN	APPROVED	PRINT DATE	DRAWING		
	JF	12/08/2020	DEVELOPMENT APPLICATION		
			LEVELS TO PLAN		
			<b>DRAFT</b>		
SCALE @ A1 1:200	STATUS <b>DA</b>	PROJECT NO. 21811	DRAWING NO. <b>DA-17</b>	ISSUE A	



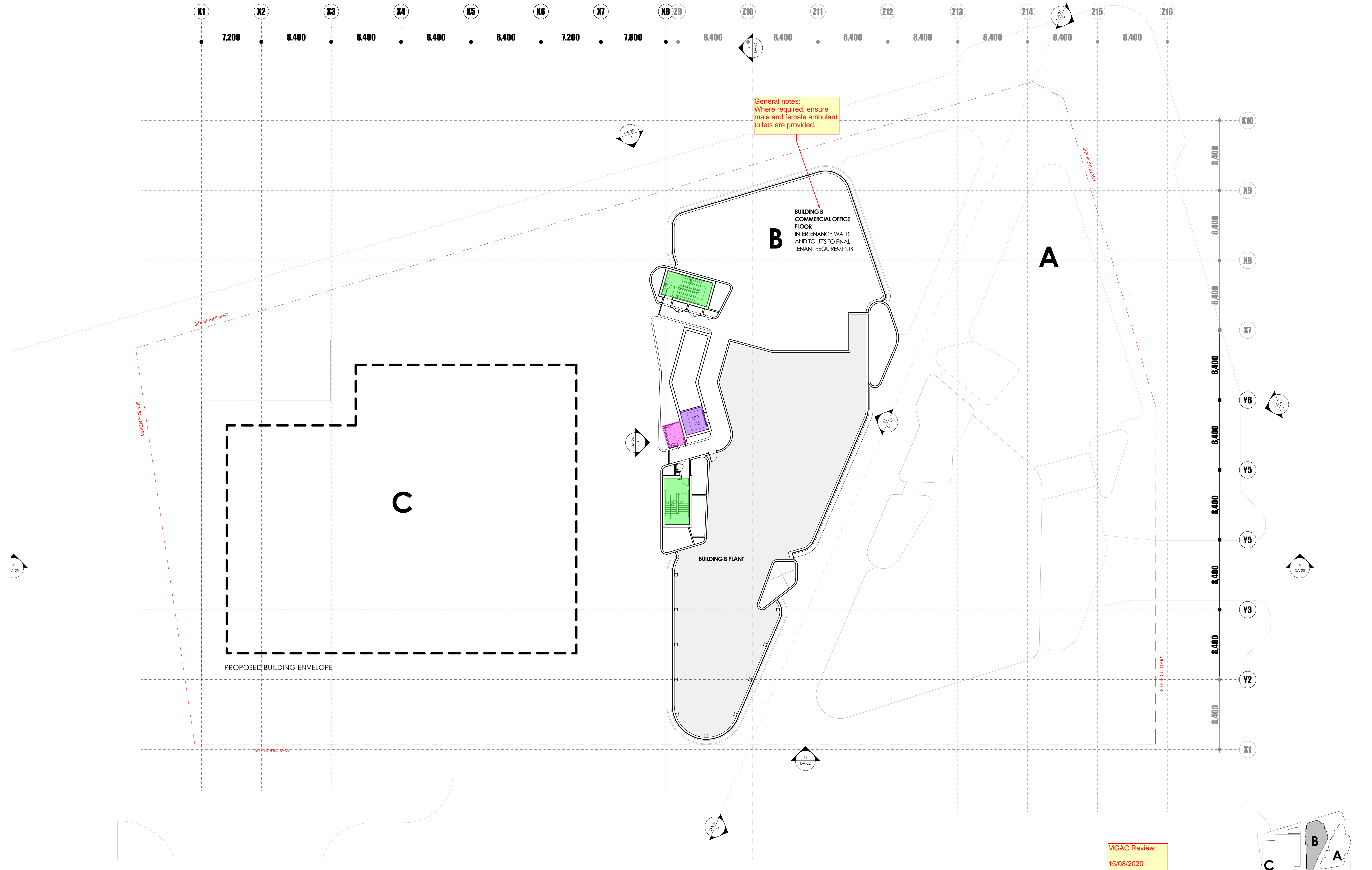

This drawing is based upon the condition it is not copied, reproduced, retained or disclosed to any unauthorised person without the prior written consent of fitzpatrick+partners.  
Do not scale drawings. Check dimensions before commencing work.  
Drawings show design intent only. Shop drawings are to be provided for approval prior to construction or manufacture.  
Inconsistencies are to be reported to fitzpatrick + partners.

REV.	DATE	DESCRIPTION
A	09.05.2020	PRE DA ISSUE
B	31.07.2020	DRAFT DA ISSUE

CHK  
JF  
JF

FOR



PROJECT  
29-57 CHRISTIE STREET  
COMMERCIAL DEVELOPMENT  
29-57 CHRISTIE STREET, ST LEONARDS NSW 2065  
PROJECT NORTH

MGAC Review:  
15/08/2020

DRAWN	APPROVED	PRINT DATE	DRAWING
JF	JF	12/08/2020	DEVELOPMENT APPLICATION LEVEL 11 PLAN - PLANT <b>DRAFT</b>
SCALE @ A1 1:200	STATUS DA	PROJECT NO. 21811	DRAWING NO. DA-18 ISSUE A

